



Orkney Property Centre

13 Bridge Street
Kirkwall
KW15 1HR
01856 877 866



info@orkneypropertycentre.co.uk

2 Building Sites at Parkhouse, South Ronaldsay, KW17 2BG Offers over £38,500 each



These two large building sites extend as follows:-

Plot 1 – 0.2585 ha (0.638 acres) and Plot 3 – 0.248 ha (0.613 acres) approximately.

Full planning permission has been granted to erect a three bedroomed dwelling house and garage on each of these serviced sites.

They have outstanding views to the north over Watersound and Burray and the northwest to Hoy.

The sites are adjacent to the B9044 South Cara public road, at the north end of South Ronaldsay. While in a rural location they are situated near a bus route and convenient for amenities in St Margaret's Hope and Burray village.

To view contact Orkney Property Centre or simply visit the site.

Interested parties should note their interest to Orkney Property Centre with whom all written offers should be submitted.

www.orkneypropertycentre.co.uk

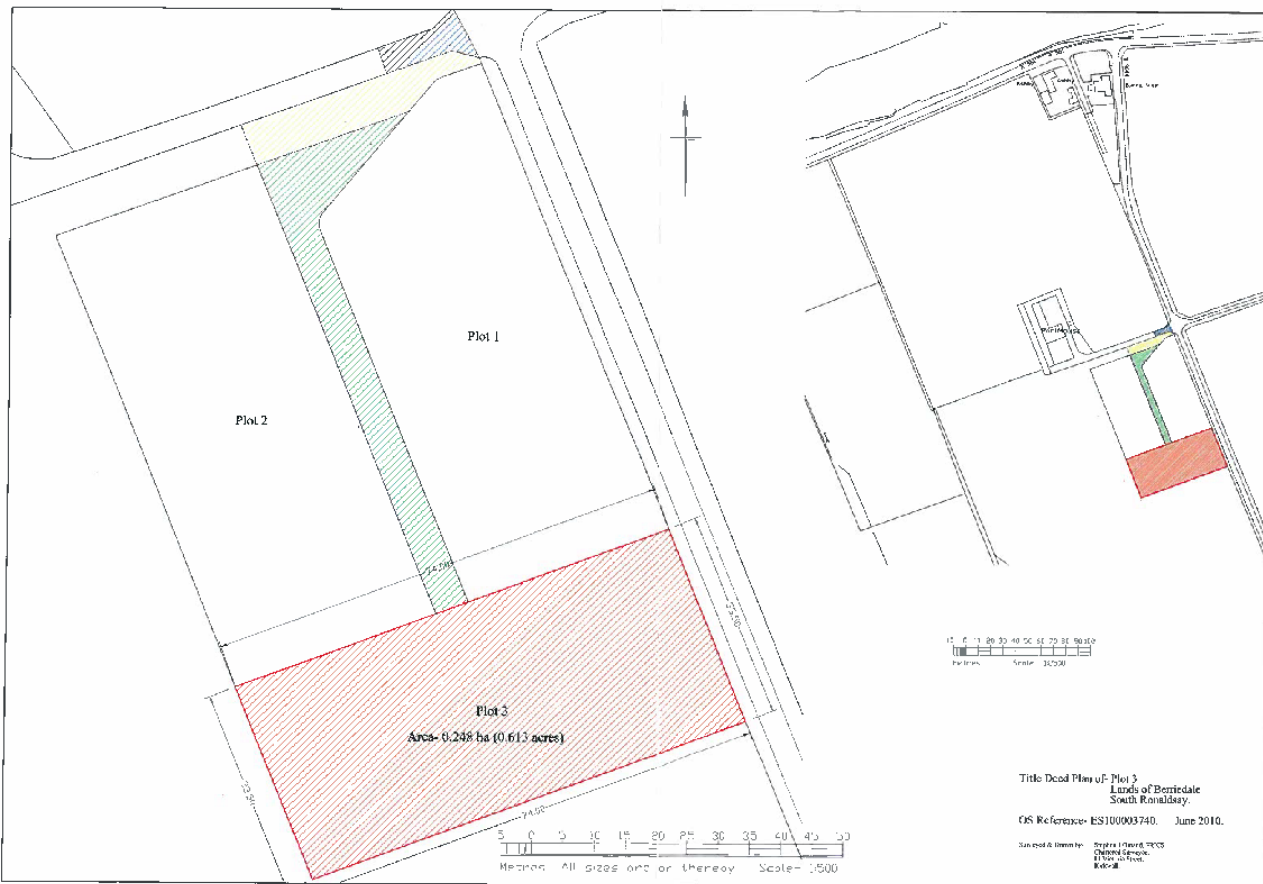
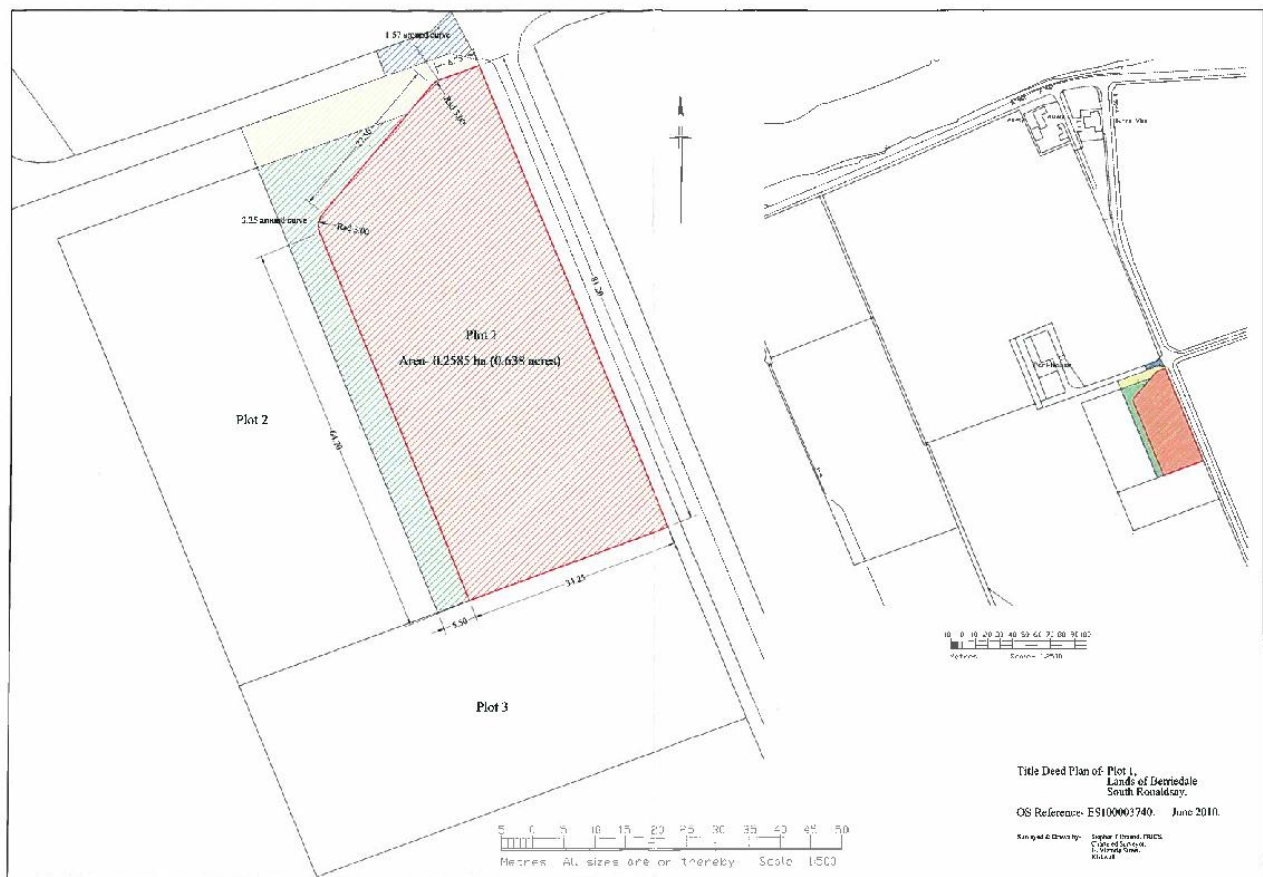



Orkney Property Centre has produced the particulars of this property, including all photographs & measurements. They are intended to be a guide for prospective purchasers and are believed to be truthful as of March 2011. All measurements are approximate sizes only. Orkney Property Centre will take no responsibility or liability for any mistakes or omissions made or any consequences thereof. The vendor maintains the right to withdraw the property from the market.